



4184 E. Conant st., Long Beach, CA 90808
Tel. 310-900-1000 Fax. 310-900-1077
www.turboairinc.com

Project :

Model # :

Item # :

Qty :

Available W/H :

Approval :

24" Wide Heavy Duty Restaurant Range

Model : TAR-4



FEATURES / BENEFITS

- HEAVY GAUGE WELDED FRAME CONSTRUCTION.
- STAINLESS STEEL FRONT, SIDES, BACK RISER LIFT-OFF HIGH SHELF.
- INDIVIDUAL PILOT FOR EACH LIFT OFF TOP OPEN BURNER AT 32,000 BTU/HR.
- 6" STAINLESS STEEL ADJUSTABLE LEGS (CASTORS AVAILABLE AS AN OPTION).
- 12" X 12" SECTIONED HEAVY DUTY CAST IRON GRATES.
- FULL SIZE PULL OUT CRUMB TRAY.
- WRAP AROUND FULL STAINLESS STEEL OVEN INTERIOR / 26.3" DEPTH STANDARD.
- FULLY ADJUSTABLE OVEN THERMOSTAT PROVIDING TEMPERATURES FROM 250-550 DEGREES.
- PULL OFF STAINLESS STEEL DOOR FOR EASY CLEANING.
- THERMOSTATICALLY CONTROLLED GRIDDLE.
- 1 STAINLESS STEEL OVEN RACK (ADDITIONAL RACKS OPTIONAL).
- CSA CERTIFIED FOR SAFETY & SANITATION FOR U.S. AND CANADA.
- A FULL ONE YEAR LIMITED PARTS AND LABOR WARRANTY.



Model	Oven	Weight (lbs.)	Width (inches)	Total BTUs	Configuration
TAR-4	1	360	24	163K	4 open burners (NAT)
TAR-4-LP	1	360	24	160K	4 open burners (LPG)

24" Wide Heavy Duty Restaurant Range

Model : TAR-4

DATA	TAR-4
Gas Type	NAT
Gas Connection	3/4"
Regulator	3/4"
Gas Pressure	5 W.C"
DIMENSIONAL DATA (unit : inch)	
Ext. Length Overall	24 (610mm)
Ext. Depth Overall	31 7/8 (810mm) + manifold
Ext. Height Overall	56 1/2 (1436mm)
OVEN DIMENSION (Interior) (unit : inch)	
Number of Oven	1
Length	20 1/8 (510mm)
Depth	26 1/4 (669mm)
Height	13 5/8 (345mm)

DATA	TAR-4-LP
Gas Type	LPG
Gas Connection	3/4"
Regulator	3/4"
Gas Pressure	10 W.C"
DIMENSIONAL DATA (unit : inch)	
Ext. Length Overall	24 (610mm)
Ext. Depth Overall	31 7/8 (810mm) + manifold
Ext. Height Overall	56 1/2 (1436mm)
OVEN DIMENSION (Interior) (unit : inch)	
Number of Oven	1
Length	20 1/8 (510mm)
Depth	26 1/4 (669mm)
Height	13 5/8 (345mm)

Design and specifications subject to change without notice.

Actual shipping weight may differ due to extra packing materials for product protection.

■ WARRANTY : 1 Year Labor and Parts Warranty

■ OPTIONAL ACCESSORIES :

- ☐ Casters (Set of 4)
- ☐ Stainless steel oven racks

PLAN VIEW

(unit : inch)

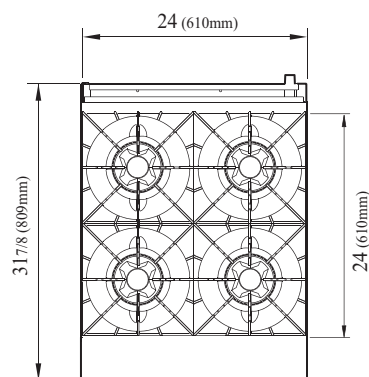

TOP VIEW

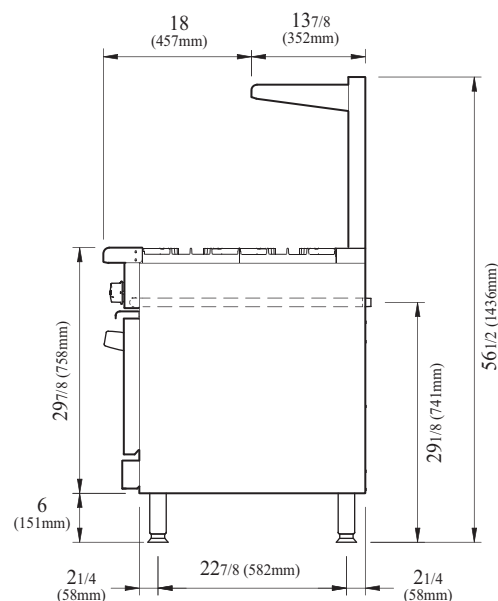

SIDE VIEW

Ver.201401



- Turbo Air : 800-627-0032 ■ GK : 800-500-3519
- Warranty : 800-381-7770 ■ AC : 888-900-1002

REFRIGERATOR MANUFACTURER
Turbo air

GERMAN
KNIFE

RADIANCE

GREEN WORLD

AIR CONDITIONER MANUFACTURER
Turbo air